

AC/DC Current Probes

CP2100 Series

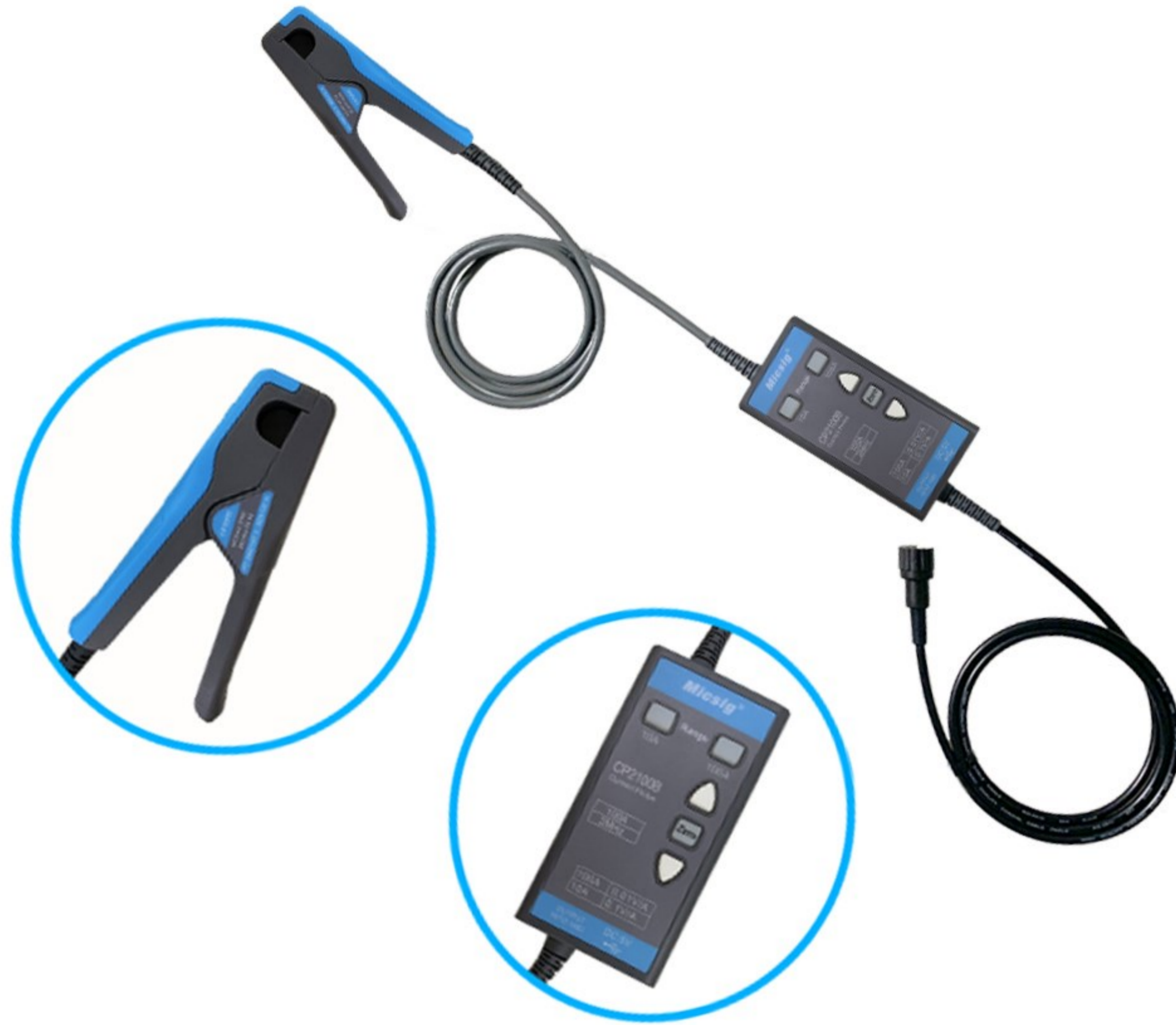

Model	CP2100A	CP2100B
Bandwidth	DC~800KHz	DC~2.5MHz
Rise time	≤583ns	≤175ns
Ranges	10A/100A	
Output sensitivity	0.1V/A (10A) 0.01V/A (100A)	
DC accuracy(typical)	3%±50mA (10A) 4%±50mA (100A, 500mA~40Apk) 15% (100A, 40Apk~100Apk)	
Signal delay	<150ns (10A) <200ns (100A)	
Current measurement range	50mA~10Apk (10A) 1A~100Apk (100A)	
Maximum measurable current	100Apk, 70.7Arms (DC+ACpk) 200Apk-pk, 70.7Arms (AC)	
Maximum working voltage	CAT III 300V CAT II 600V	
Maximum float voltage	CAT III 300V CAT II 600V	
Maximum conductor diameter	13mm	
Overload indication	The buzzer beeping, the button light flashing	
Power supply	DC 5V	
Probe head size	11*6.1*2.5cm	
Control box size	10.8*5.6*2.6cm	

Key performance specifications

- Bandwidths up to 2.5 MHz
- Powered by USB, making measurement easier
- Both automatic and manual zero adjustments are available
- Maximum measurable current, 100Apk, 70.7Arms (DC+ACpk)

Shenzhen Micsig Instruments Co., Ltd.

Tel: +86-755-86-88600880

Web: www.micsig.com

E-mail: sales@micsig.com

Add: 305 Block A, CLOU Building, Baoshen RD, North Area, Nanshan Science & Technology Park, Shenzhen, Guangdong, China . 518000